

LWGX-TPA series

Blickle WAVE synthetic castors, corrosion-resistant, with stem, colour silver grey, wheel with thermoplastic rubber tread



100–110 kg

-20 °C to +60 °C

Bracket: LWGX series

- high-quality nylon 6, impact resistant
- moulded corrosion-resistant grooved ball bearing in the swivel head sealed on both sides
- with stainless steel plug-in stem, bolted and secured
- colour silver grey RAL 7001
- all parts including axle material are corrosion-resistant
- modern, appealing design

Wheel: TPA series

- tread: high-quality thermoplastic rubber-elastomer (TPE), hardness 85 Shore A, colour grey, non-marking, oil containing
- wheel centre: high-quality polypropylene, impact resistant, colour silver grey RAL 7001

Other features:

- the load capacity reduces at ambient temperatures above +30 °C

Additional details:

- bracket series: page 89
- brakes: page 112–113
- wheel series: page 60
- bearing types: page 84–85



2

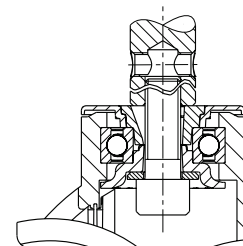

Swivel castors	Swivel castors with "stop-fix" brake	Wheel Ø [mm]	Wheel width [mm]	Load capacity [kg]	Bearing type	Total height [mm]	Stem Ø (D) [mm]	Stem length [mm]	Ø cross hole [mm]	Position cross hole (H) [mm]	Offset swivel castor [mm]
LWGX-TPA 101G-ZAX51	LWGX-TPA 101G-FI-ZAX51	100	32	100	plain bore	135	18	62	M6	30	38
LWGX-TPA 101G-ZAX55	LWGX-TPA 101G-FI-ZAX55	100	32	100	plain bore	135	22	45	M8	20	38
LWGX-TPA 101XKF-ZAX51	LWGX-TPA 101XKF-FI-ZAX51	100	32	100	ball bearing (C)	135	18	62	M6	30	38
LWGX-TPA 101XKF-ZAX55	LWGX-TPA 101XKF-FI-ZAX55	100	32	100	ball bearing (C)	135	22	45	M8	20	38
LWGX-TPA 126G-ZAX51	LWGX-TPA 126G-FI-ZAX51	125	32	110	plain bore	160	18	62	M6	30	40
LWGX-TPA 126G-ZAX55	LWGX-TPA 126G-FI-ZAX55	125	32	110	plain bore	160	22	45	M8	20	40
LWGX-TPA 126XKF-ZAX51	LWGX-TPA 126XKF-FI-ZAX51	125	32	110	ball bearing (C)	160	18	62	M6	30	40
LWGX-TPA 126XKF-ZAX55	LWGX-TPA 126XKF-FI-ZAX55	125	32	110	ball bearing (C)	160	22	45	M8	20	40

Additional stem fitting dimensions available upon request

Versions / options



	plain bore version	electrically conductive version, non-marking, grey	in special colour
Technical description page		50	
Product code suffix		LWGXE-...-ELS	
Available for		all ball bearing versions*	upon request

* Load capacity of electrically conductive version reduced by 35%